

# GEROY IGOR ASEEV

Pusher tug, type BTO



**MORWENNA**  
Shipping Company

- Barges • Pusher & Towing Tugs • Towages of all types •
- Heavy-lift and outside cargo shipment •
- Technical management •

[www.mwship.com](http://www.mwship.com)

# GEROY IGOR ASEEV • PUSHER TUG

YEAR OF BUILD:	DEPTH:
1986	3,70 m
PLACE OF BUILD:	DRAFT:
USSR, Zvenigovo	2,40 m / 2,55 m
LENGTH OVERALL:	POWER:
29,40 m	1170 h.p.
BEAM:	BOLLARD PULL:
9,60 m	9,50 t
PORT OF REGISTRY:	REGISTER NUMBER:
Novorossiysk	219075



CLASS:

RRR, ⚓ M-PR 2,5 | Ice Class: (Ice 30) A

• Project 81200 •

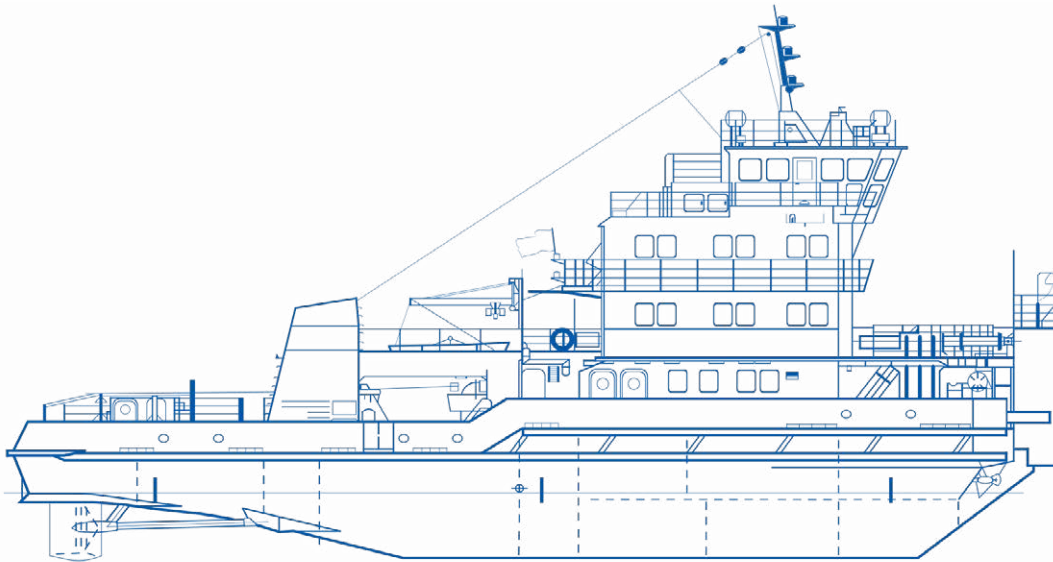

Side view

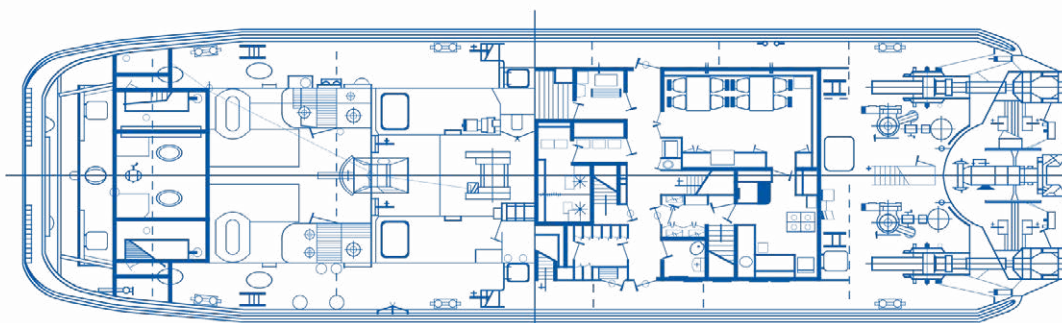

Top view

## PROPULSION

MAIN ENGINES:	2x 6CHN21/21
POWER:	2x 430 kW / 585 h.p.
RUDDERS:	1x 2RG 4,0/51, 2x steering nozzles
PROPELLERS:	2x fixed pitch, with nozzles
DESIGN BOLLARD PULL:	9,50 t

## AUXILIARIES

DIESEL GENERATOR SETS:	2x SD 245
DIESEL GENERATOR POWER:	2x 67 kW
SEWAGE PUMP:	FG 14.6/10 Q=14,6 m <sup>3</sup> /h; P=0,1 MPa

## RADIONAVIGATION EQUIPMENT

CALL SIGN:	UILQ
E-MAIL/INTERNET:	available
VHF (C/W DSC) RADIOTELEPHONE:	IC-M302; Samyung STR-580 D
MH/HF RADIOTELEPHONE:	SRG-1250DN
RADAR №1:	Bridge Master E / 121025/ 2 Litton Marine Systems
RADAR №2:	Koden / 10810423 Koden Electronic
ECHO SOUNDER:	F-3000
MAGNETIC COMPASS:	UPK-M-127 mm / 747
AIS:	Samyung SI-30R
GPS:	Furuno GP-32
GPS/GLONASS:	Transas T-701

## CAPACITIES

DIESEL FUEL:	30,00 t
LUB OIL:	1,00 t
BALLAST WATER:	30,00 t
BILGE WATER:	4,60 t
SEWAGE:	6,00 t
DIRTY OIL:	0,60 t

## ACCOMODATION

TOTAL POB:	11
CABINS:	9
CREW:	11
MAX QUANTITY OF PASSANGERS ONBOARD:	2

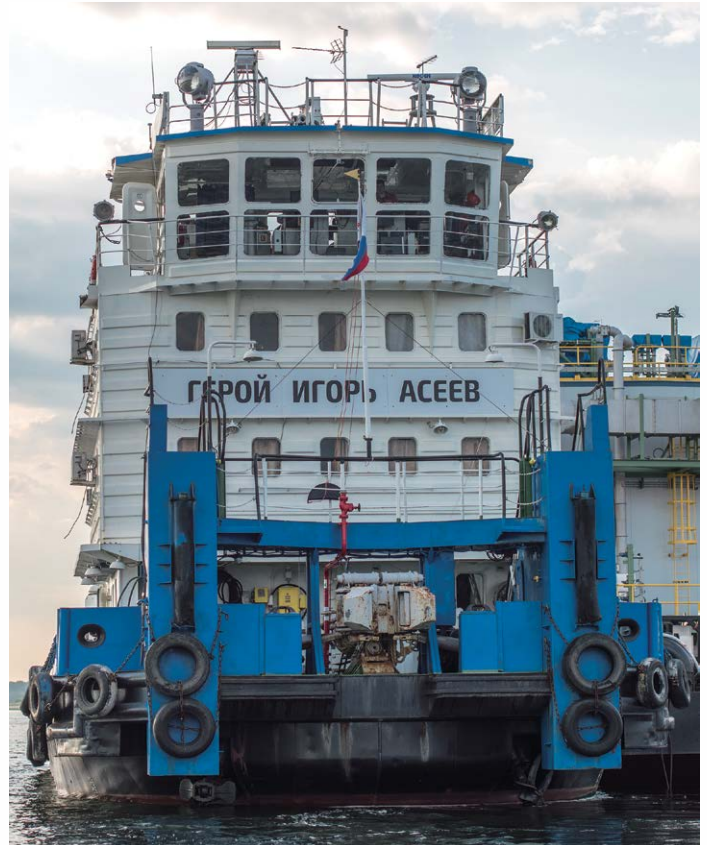

## TOWING AND ANCHOR HANDLING

WINDLASS NO.1:	YSH2
WINDLASS NO.2:	YSH2
TOWING WINCH:	GLB 6/12
TOWING/ANCHOR WINCH:	GLB 6/12
TOWING WINCH BOLLARD PULL:	9,50 t
BARGE WINCHES:	BN-400
TOWING WINCH DRUM CAPACITY:	300 m
SPARE TOWING TOWLINE:	1x 29 mm x 270 m
COUPLING DEVICE:	1x O-150T-8; 2x BN-400
ANCHOR GEAR	anchor Hall

## LIFE SAVING APPLIANCES & EQUIPMENT

LIFERAFTS:	2x Viking 20DK+
LIFEJACKETS:	19x JSM-Cyclone
PYROTECHNICS:	2x PRB-40, 6x ZRB-40, 6x red flares
FI-FI PUMPS:	2x K-45/55; Q=50 m <sup>3</sup> /h, P=0,5 MPa
FI-FI FOAM SYSTEM:	MORPEN

More than 40 fleet units:

### KPT2500-1C PUSHER TUG

NEWBUILT



3 units  
Multipurpose AHT, Supply Vessels with Ice class 1A

MB Project 07521



3 units  
Tugs with Ice Class IC

RT-600 Project 1741AM



1 unit  
Pusher Tug with Ice Class (Ice 10)A

OT-2000 Project 428.1



1 unit  
Pusher Tug with Ice Class IC

### CHEMBA

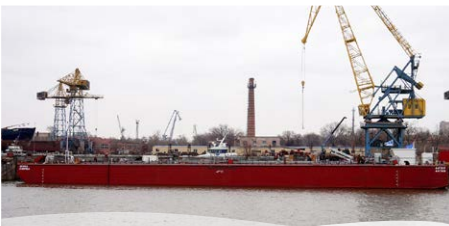

1 unit  
Methanol barge

RORO-PONTOON 6516 Project 6516



1 unit  
RORO-pontoon with Ice Class IC

### ARCTIC



1 unit  
Multipurpose AHT, Supply Vessel with Ice class 1A

### SILVER LOWENNA



1 unit  
Multipurpose AHT with Ice Class ICE

BT0 Project 81200



3 units  
Pusher Tugs with Ice Class (Ice 30)A

OT-2400 Project N-3290/3291



8 units  
Pusher Tugs with Ice Class (Ice 20)A

### RORO-PONTOONS

Project 8916



11 units  
RORO-pontoons with Ice Class IC

RORO-PONTOON GRPN Project 8516



1 unit  
RORO-pontoon with Ice Class 3

### IEVOLI ORANGE



1 unit  
Multipurpose AHT, Supply Vessel with Ice class 1A

### SOWENA



1 unit  
Multipurpose AHT with Ice Class ICE

OZERNY Project N-3180



1 unit  
Pusher Tug with Ice Class IC

OTA-800 Project 758AM



1 unit  
Pusher Tug with Ice Class (Ice 20)

### RORO-PONTOONS SIMMAR

Project 9516



2 units  
RORO-pontoons with Ice Class ICE

### RORO-PONTOONS 16801

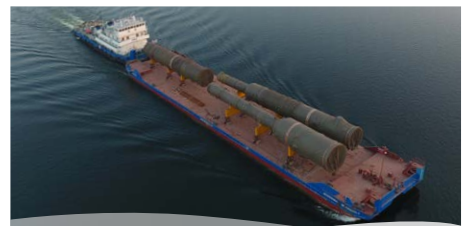

3 units  
RORO-pontoons

@morwennashipping

See all of our fleet on website: [WWW.MWSHIP.COM](http://WWW.MWSHIP.COM)

TEL.: +7 (495) 151-85-20  
E-MAIL: chartering@mwship.com  
HEAD Office №20018, Golovinskoe shosse 5-1,  
OFFICE: business center «Vodny», Moscow, 125212, Russia

Morwenna Shipping company LTD.

