

GEROI ZAPOLYARYA

Pusher tug, type BTO



MORWENNA
Shipping Company

- Barges • Pusher & Towing Tugs • Towages of all types •
- Heavy-lift and outsize cargo shipment •
- Technical management •

www.mwship.com

GEROI ZAPOLYARYA • PUSHER TUG

YEAR OF BUILD: 1991	DEPTH: 3,70 m
PLACE OF BUILD: USSR, Zvenigovo	DRAFT: 2,27 m / 2,53 m
LENGTH OVERALL: 29,40 m	POWER: 930 h.p.
BEAM: 9,60 m	BOLLARD PULL: 12 t
PORT OF REGISTRY: Astrakhan	REGISTER NUMBER: 226925

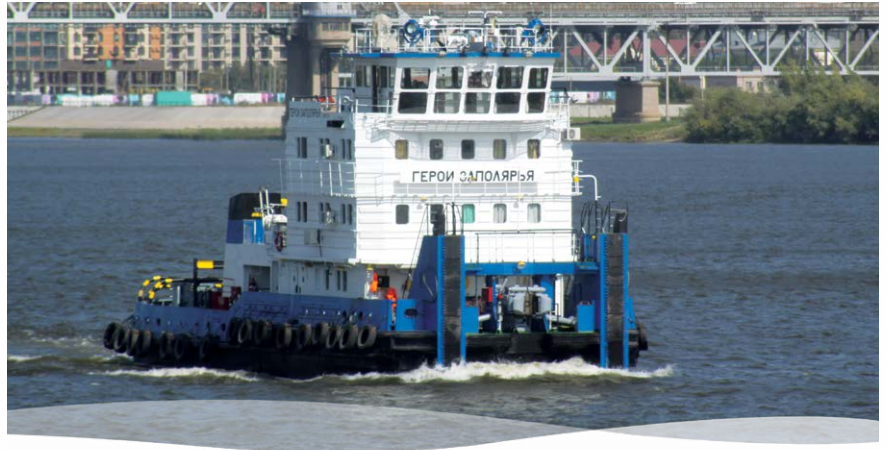

CLASS:

RRR, ⚓ O2,0 | Ice Class: (Ice 20) A

• Project 81200 •

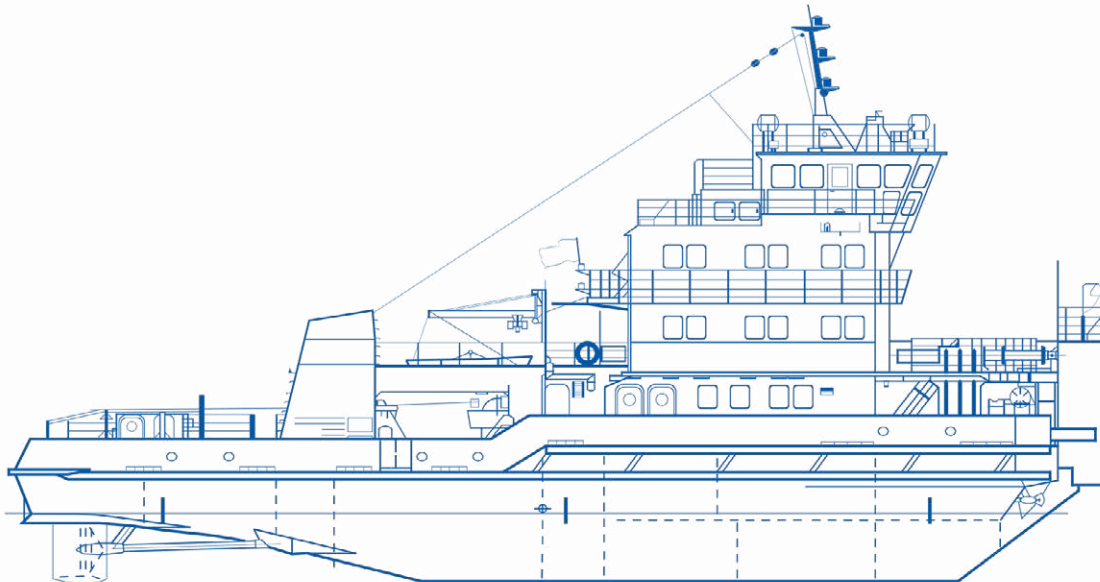

Side view

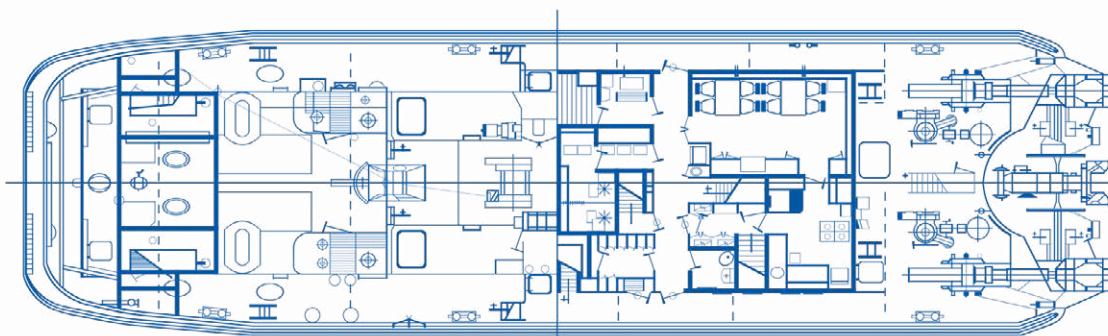

Top view

PROPULSION

MAIN ENGINES:	2x 8 CHN 14/14
POWER:	930 h.p. / 684 kW
PROPELLERS:	2x fixed pitch
DESIGN BOLLARD PULL:	12 t

AUXILIARIES

DIESEL GENERATOR SETS:	2x 6CHN 11/12,5
DIESEL GENERATOR POWER:	2x 77 kW
SEWAGE PUMP:	FG 14,5/10

RADIONAVIGATION EQUIPMENT

CALL SIGN:	UBTU3
E-MAIL/INTERNET:	available
VHF (C/W DSC) RADIOTELEPHONE:	Granite R-24
MH/HF RADIOTELEPHONE:	Angara-RA
RADAR:	Furuno FR-7062
ECHO SOUNDER:	NEL-M4
MAGNETIC COMPASS:	Saura MR-150
AIS:	Transas T-104
GPS/GLONASS:	Transas T-701



TOWING AND ANCHOR HANDLING

WINDLASS NO.1:	YSH2R
WINDLASS NO.2:	YSH2R
TOWING WINCH:	LGD/6-12
TOWING/ANCHOR WINCH:	LGD/6-12
TOWING WINCH BOLLARD PULL:	6 t
BARGE WINCHES:	BN-400
TOWING WINCH DRUM CAPACITY:	400 m
CHAIN LOCKERS:	caliber 22
ANCHORS:	bow - Hall 300 kg; stern - Hall 1000 kg



CAPACITIES

DIESEL FUEL:	35,00 t
LUB OIL:	1,20 t
BALLAST WATER:	26,00 t
BILGE WATER:	4,45 t
SEWAGE:	6,00 m ³
DIRTY OIL:	0,79 m ³

ACCOMODATION

TOTAL POB:	12
CABINS:	9
CREW:	12
MAX QUANTITY OF PASSANGERS ONBOARD:	2

LIFE SAVING APPLIANCES & EQUIPMENT

LIFERAFTS:	PSR-20 U
LIFEJACKETS:	15x
PYROTECHNICS:	6x PRB 40, 6x FKO
FI-FI PUMPS:	2x K-45/55; Q=50 m ³ /h, P=0,5 MPa
FI-FI FOAM SYSTEM:	Foam concentrate tank - 1 m3

More than 40 fleet units:

KPT2500-1C PUSHER TUG

NEWBUILT



3 units
Multipurpose AHT, Supply Vessels with Ice class IC

MB Project 07521



3 units
Tugs with Ice Class IC

RT-600 Project 1741AM



1 unit
Pusher Tug with Ice Class (Ice 10)A

OT-2000 Project 428.1



1 unit
Pusher Tug with Ice Class IC

CHEMBA

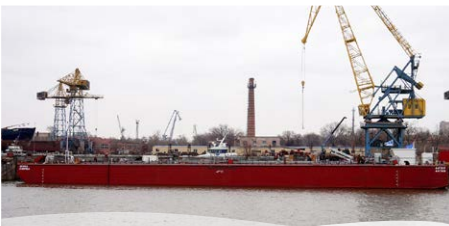

1 unit
Methanol barge

RORO-PONTOON 6516 Project 6516



1 unit
RORO-pontoon with Ice Class IC

ARCTIC



1 unit
Multipurpose AHT, Supply Vessel with Ice class 1A

SILVER LOWENNA



1 unit
Multipurpose AHT with Ice Class ICE

BT0 Project 81200



3 units
Pusher Tugs with Ice Class (Ice 30)A

OT-2400 Project N-3290/3291



8 units
Pusher Tugs with Ice Class (Ice 20)A

RORO-PONTOONS Project 8916



11 units
RORO-pontoons with Ice Class IC

RORO-PONTOON GRPN Project 8516



1 unit
RORO-pontoon with Ice Class 3

IEVOLI ORANGE



1 unit
Multipurpose AHT, Supply Vessel with Ice class 1A

SOWENA



1 unit
Multipurpose AHT with Ice Class ICE

OZERNY Project N-3180



1 unit
Pusher Tug with Ice Class IC

OTA-800 Project 758AM



1 unit
Pusher Tug with Ice Class (Ice 20)

RORO-PONTOONS SIMMAR Project 9516



2 units
RORO-pontoons with Ice Class ICE

RORO-PONTOONS 16801

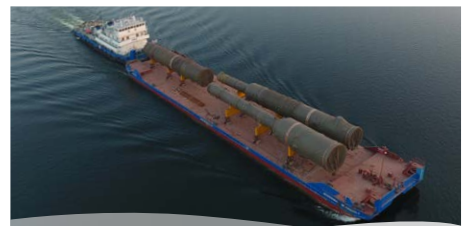

3 units
RORO-pontoons

@morwennashipping

See all of our fleet on website: WWW.MWSHIP.COM

TEL.: +7 (495) 151-85-20
E-MAIL: chartering@mwship.com
HEAD Office №20018, Golovinskoe shosse 5-1,
OFFICE: business center «Vodny», Moscow, 125212, Russia

Morwenna Shipping company LTD.

